



VER VÍDEO



WATCH VIDEO

WC

Características Técnicas

- Previene los escapes por presión estática en flexo y duchita.
- Evita siniestros por inundaciones.
- Evita recirculación del agua.
- Montaje en dos cuerpos.
- Garantía de 5 años en grifería y 2 años en complementos.

Technical Characteristics

- Prevents leakage by static pressure in the flexible and shower.
- Avoid damages by floods.
- Avoid water recirculation.
- Assembly in two bodies.
- 5 years warranty on taps and 2 years on accessories.



WC



CR



NM



NC



OC

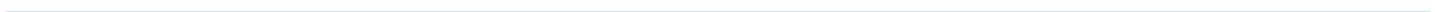



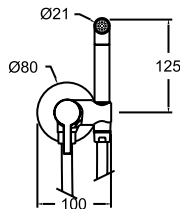
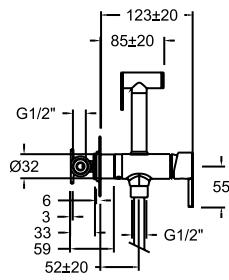

336801WC

99F302081
336801S+9552+1120CHP

336801WCNM

99F305564
336801SNM+9552NM+1121CNCM

336801WCNC

99F305571
336801SNC+9552NC+1121CNC

336801WCOC

99F305569
336801SOC+9552OC+1121CO

Monomando empotrado de WC Magnet con cierre doble cierre de seguridad y duchita.

Single lever WC Magnet with double closing safety lock and shower.



336801S

99F302575
XX6801+3300-25

336801SNM

99F305561
XX6801NM+3300-25NM

336801SNC

99F305570
XX6801NC+3300-25NC

336801SOC

99F305568
XX6801OC+3300-25OC

Monomando empotrado de WC Magnet con cierre doble cierre de seguridad sin accesorios.

Single lever WC Magnet with double closing safety lock without accessories.

Cartucho Cartridge: 25000-2



PME01

AAZ302651

Placa necesaria para montaje en pladur.
Plate needed for mounting in plasterboard.

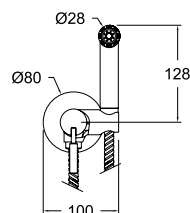
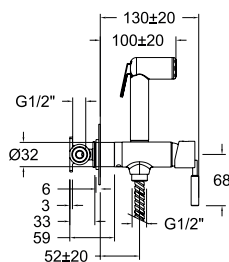

756801WC

99F302574
756801S+955102+247903C

Monomando empotrado de WC Magnet con cierre doble cierre de seguridad y duchita.

Single lever WC magnet with double closing safety lock and shower..

756801S

99F302573
XX6801+7500-25

Monomando empotrado de WC Magnet con cierre doble cierre de seguridad sin accesorios.

Single lever WC Magnet with double closing safety lock without accessories..

Cartucho Cartridge: 25000-2



PME01

AAZ302651

Placa necesaria para montaje en pladur.
Plate needed for mounting in plasterboard.



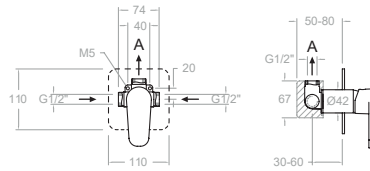

364502

36F308298
361801S+3796+9560+247903C

364502NM

36F308300
361801SNM+3796NM+9560NM+1121CNM

364502NC

36F308299
361801SNC+3796NC+9560NC+1121CNC

364502OC

36F308301
361801SOC+3796OC+9560OC+1121COC

Monomando empotrado de WC con duchita.
Single lever WC with shower.

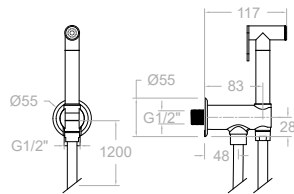

114604WC

99F308833
379802+9552+1120CHP

114604WCNM

99F308834
379802NM+9552NM+1121CNM

114604WCOC

99F308835
379802OC+9552OC+1121COC

Conjunto de duchita para WC de una agua.
Shower set for single water WC.



Disponible en Julio
Available in July

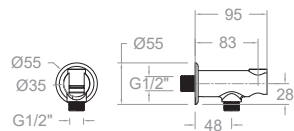

379802

99Z308830

379802NM

99Z308831

379802OC

99Z308832

Llave de paso con cierre automático.
Angle valve with automatic stop.

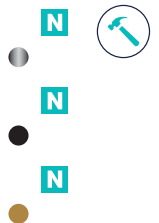

Disponible en Julio
Available in July

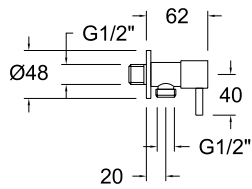

3797
230514

3797NM
99Z306002

3797NC
99Z308649

3797OC
99Z308648

3797CUC
99Z308650

Llave de paso cerámica de 1/2".
1/2" ceramic angle valve.

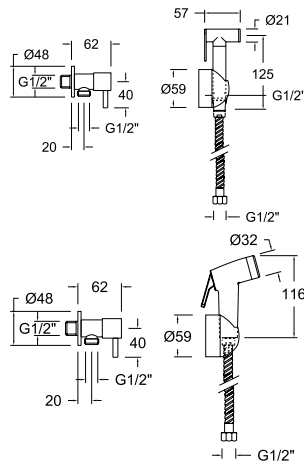
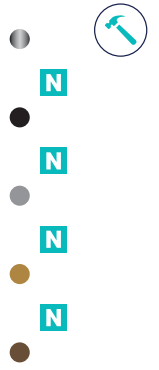

114102

99F301561
3797-9552+354802+247903C

Conjunto para WC con duchita de latón.
WC set with brass shattaf.

114202

99F301562
3797-955102+354802+247902C

Conjunto para WC con duchita de ABS.
WC set with ABS shattaf.

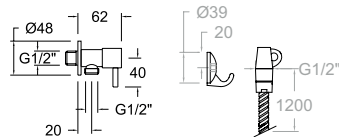
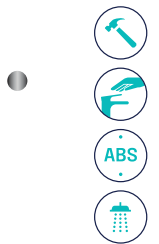

114702

99F301563
3797-3799+247902C

Conjunto para WC.
WC set.

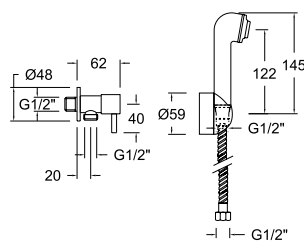
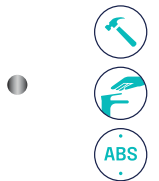

114902

99F301565
3797-9553+354802+247902C

Conjunto para WC.
WC set.

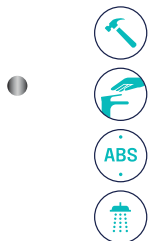

WC

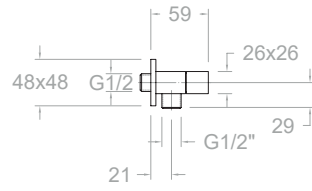

4797
242304

Llave de paso cerámica de 1/2".
Ceramic angle valve 1/2"..

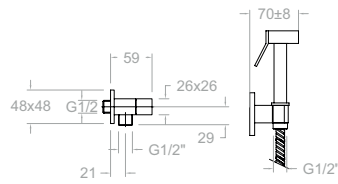

411902

99F301571
4797+4552+4741+247903C

Conjunto para WC.
WC set.

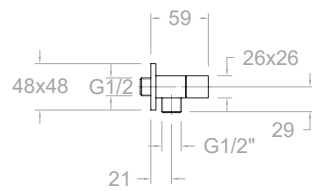

411702

99F301569
4797+3799+247903C

Conjunto para WC.
WC set.

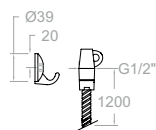

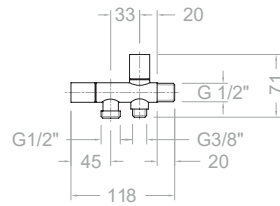

3793

99Z303339

Llave de paso cerámica con dos salidas (cisterna WC+ duchita WC).
Ceramic angle valve with 2 outlets (WC tank + shattaf).



3795

300150

Llave de paso cerámica con dos salidas (cisterna WC+ duchita WC).
Ceramic angle valve with 2 outlets (WC tank + shattaf).

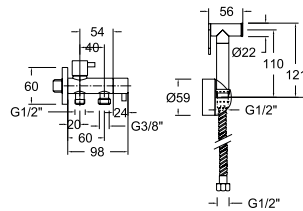

113702

99F301567

3793+9552+354802+247903C

Conjunto de WC para duchita y cisterna de WC.
WC set for shattaf and WC tank.



WC

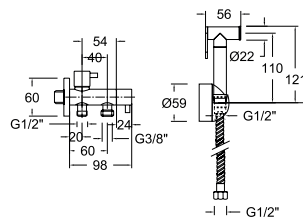

113502

99F301566

3793+955102+354802+247902C

Conjunto de WC para duchita y cisterna de WC.
WC set for shattaf and WC tank.



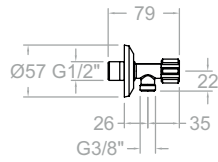

1288
AAZ301266

Llave de paso de 1/2" y 3/8".
Standard angle valve 1/2" and 3/8".

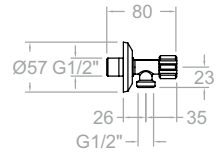

1289
AAZ301267

Llave de paso de 1/2" y 1/2".
Standard angle valve 1/2" - 1/2".

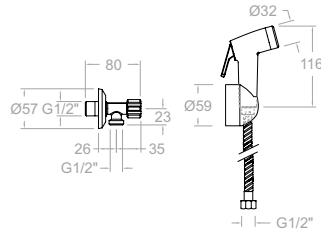

115601
99F301558

1289-955102+354802+247902C

Conjunto para WC.
WC set.

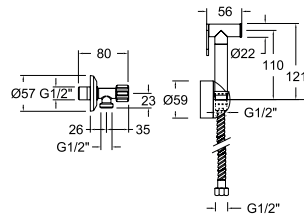

115701
99F301559

1289-9552+354802+247903C

Conjunto para WC.
WC set.

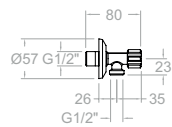

115801
99F301560

1289-3799+247902C

Conjunto para WC.
WC set.

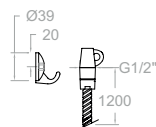

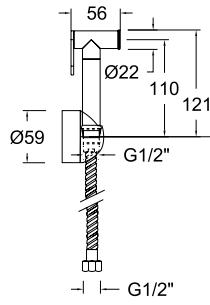

115202

99F301574

95512+354802+247903C

Conjunto WC sin llave de paso.
WC set without angle valve.

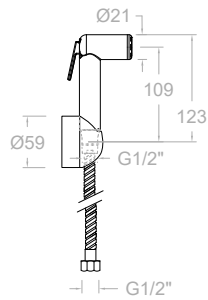

115102

99F301572

955102+354802+247902C

Conjunto WC sin llave de paso.
WC set without angle valve.



WC

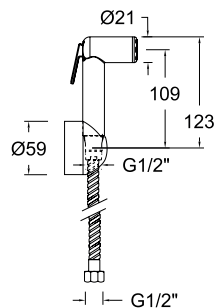

115103

99F303323

955102+354802+1122CHP

Conjunto WC sin llave de paso.
WC set without angle valve.



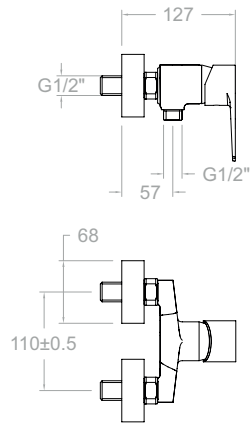

1843S
18F301575
XX43+1800-35

Monomando mural para WC.
Single lever mixer for WC.

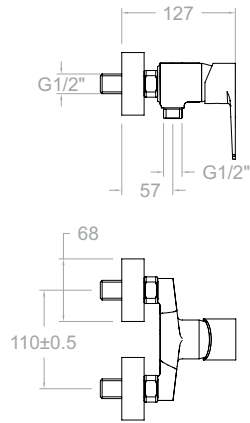

3643S
36F301692
XX43+3600-35

Monomando mural para WC.
Single lever mixer for WC.

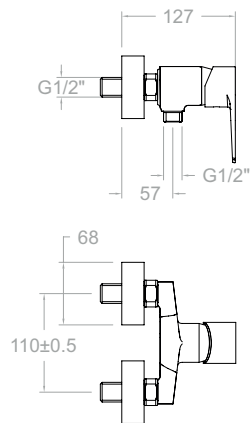

3343S
33F301581
XX43+3300-35

Monomando mural para WC.
Single lever mixer for WC.



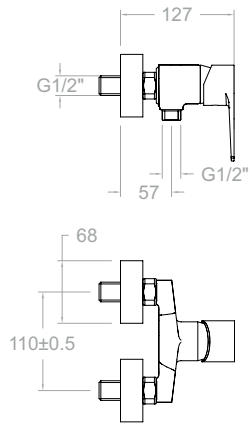

6443S
64F301580
XX43-6400-35

Monomando mural para WC.
Single lever mixer for WC.



574301S
57F304992
XX43-5700-35

Monomando mural para WC.
Single lever mixer for WC.



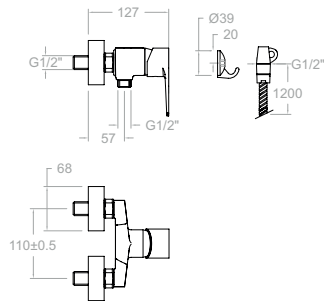

1843WC

99F300597

1843S+3799+247902C

Monomando mural para WC con accesorios de ABS.
Single lever wall mounted WC mixer with ABS accessories.



3643WC

36F301693

3643S+3799+247902C

Monomando mural para WC con accesorios de ABS.
Single lever wall mounted WC mixer with ABS accessories.



334302WC

33F301342

3343S+3799+247902C

Monomando mural para WC con accesorios de ABS.
Single lever wall mounted WC mixer with ABS accessories.



6443WC

99F300600

6443S+3799+247902C

Monomando mural para WC con accesorios de ABS.
Single lever wall mounted WC mixer with ABS accessories.



574301WC

57F304993

574301S+3799+247902C

Monomando mural para WC con accesorios de ABS.
Single lever wall mounted WC mixer with ABS accessories.

Cartucho Cartridge: 35000-3

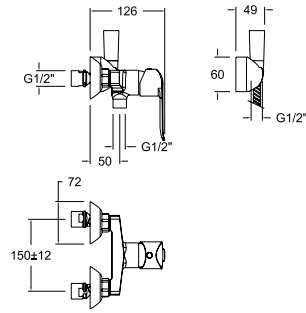
**184403WC**

18F305170

1843S+9559+354802+247902C

Monomando mural para WC con ducha de metal.
Single lever mixer 110 mm with shattaf set.

**364403WC**

36F305172

3643S+9559+354802+247902C

Monomando mural para WC con ducha de metal.
Single lever mixer 110 mm with shattaf set.

**334403WC**

33F305171

3343S+9559+354802+247903C

Monomando mural para WC con ducha de metal.
Single lever mixer 110 mm with shattaf set.

**644403WC**

64F305174

6443S+9559+354802+247902C

Monomando mural para WC con ducha de metal.
Single lever mixer 110 mm with shattaf set.

**574403WC**

57F305173

574301S+9559+354802+247902C

Monomando mural para WC con ducha de metal.
Single lever mixer 110 mm with shattaf set.

Cartucho Cartridge: 35000-3

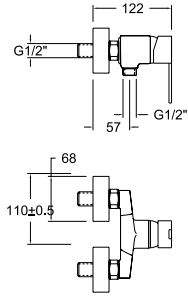

4943S

49F301576

XX43+1329+4900-35

Monomando mural para WC.
Single lever wall mounted WC mixer.

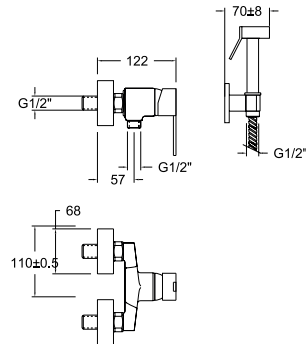

4944WC

99F300800

4943S+4552+4741+247903C

Monomando mural para WC con accesorios.
Single lever wall mounted WC mixer with accessories.



Cartucho Cartridge: 252978

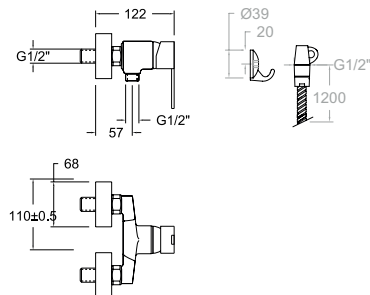

4943WC

99F300602

4943S+3799+247903C

Monomando mural para WC con accesorios.
Single lever wall mounted WC mixer with accessories.



Cartucho Cartridge: 252978



1121CNM
99Z302172



1121CNC
99Z302323



1121COC
99Z302324



Flexible 1,2 m.
High pressure flexible hose 1,2 m.



1120CHP
AAZ301305



Flexible de alta presión para Wc 1,2 m.
High pressure flexible hose for shataff 1,2 m.

1122CHP
AAZ302809



Flexible de alta presión para Wc 1 m.
High pressure flexible hose for shataff 1 m.



247902C
99Z305409



Flexible de alta presión para Wc 1 m.
High pressure flexible hose for Wc 1 m.



247903C
99Z307905



Flexible de alta presión para Wc 1,2 m.
High pressure flexible hose for shataff 1,2 m.



3796
227490



3796NM
99Z302357



3796NC
99Z302356



3796OC
99Z302358



3796CUC
99Z307678



Codo de salida de agua y soporte fijo.
Metallic water outlet with handshower support.



354802
99Z302082



354802NM
99Z309136



354802NC
99Z309025



354802OC
99Z309026



354802CUC
99Z309027



Soporte de pared para ducha.
Shower support.



4727
99Z309456



4727NM
99Z309458



4727NC
99Z309460



4727OC
99Z309459



4727CUC
99Z309461



Soporte de ABS de pared para ducha.
ABS shower wall support.



4741
300152



4741NM
99Z306003



Soporte metálico de pared para ducha.
Metal shower wall support.



9560
99Z308292

9560NM
99Z308294

9560NC
99Z308297

9560OC
99Z308295

Ducha de mano de 1 agua para WC.
1-water hand shower for WC.



9552
230037

9552NM
99Z304159

9552NC
99Z304161

9552OC
99Z304160

Ducha de latón de mano para WC.
Brass shataff for WC.



9553
199833

Ducha de mano para WC.
Handshower for WC.



4552
300151

Ducha de mano para WC.
Handshower for WC.



955102
99Z304035

Ducha de mano para WC.
Handshower for WC.



3799
240621

Director de chorro M1/2.
Chrome spray shower M1/2.



9559
99Z304408

Ducha de mano para WC de latón.
Brass WC hand shower.





WC